

ALL OPERATIONS MUST BE CARRIED OUT BY QUALIFIED PERSON

- ① Put the template on the ceiling and drill the two fixing holes.
Pay attention to center the big hole with the main power cables exit.
(It's also possible to fix the lamp to the wall).
Fix the bracket with the screws.

Mettere la dima sul soffitto e forare i due fori di fissaggio.

Fate attenzione a centrare il foro grande con l'uscita cavi dal muro.

(È possibile anche il fissaggio a parete).
Fissare la staffa con le viti.

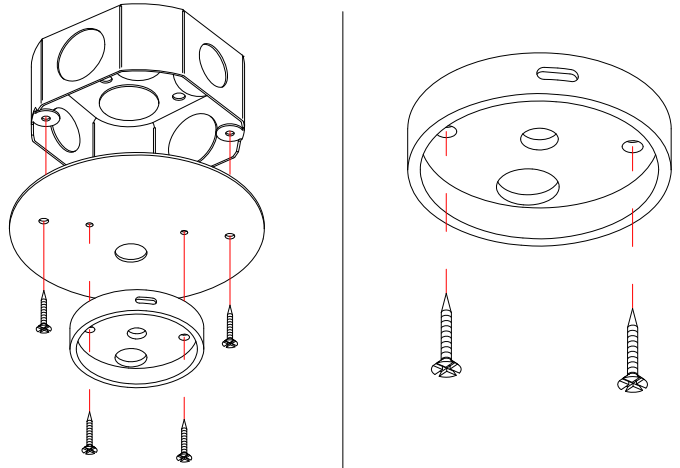

USA

CE

- ② Insert the cable of the Solitario SO in the cable-lock cylinder as shown in the image.

Inserire il cavo del Solitario SO nel cilindro bloccacavo come mostrato nell'immagine.

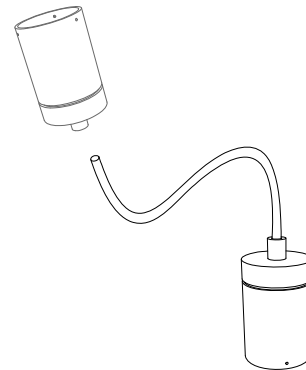

- ③ Connect the lamp to the main power following the sketch.
Make sure that the canopy's cylinder is screwed all the way on its support.

Collegare la lampada alla corrente seguendo lo schema.

Assicurarsi che il cilindro del rosone sia avvitato fino in fondo sul suo supporto.

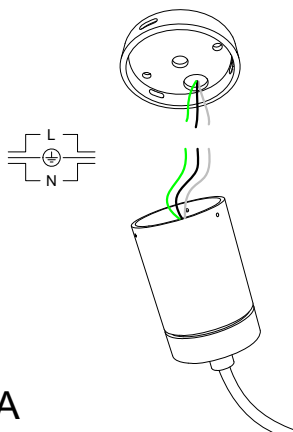

USA

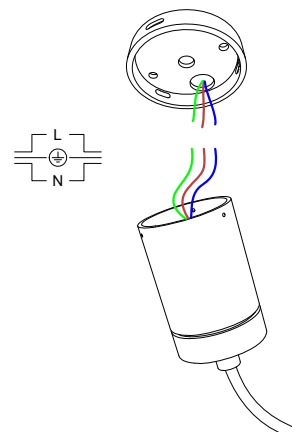

CE

ALL OPERATIONS MUST BE CARRIED OUT BY QUALIFIED PERSON

- ④ Fix the canopy to the bracket using the three screws provided.

 Fissare il rosone alla staffa utilizzando le tre viti fornite.

- ⑤ Apply the desired sphere "Smoke", "Flood" or "Spot" 120 or 200 mm diameter or the lens "Flood" or "Spot" using the provided screws.

 Applicare la sfera desiderata "Smoke", "Flood" o "Spot" 120 o 200 mm di diametro o la lente "Flood" o "Spot" utilizzando le viti fornite.

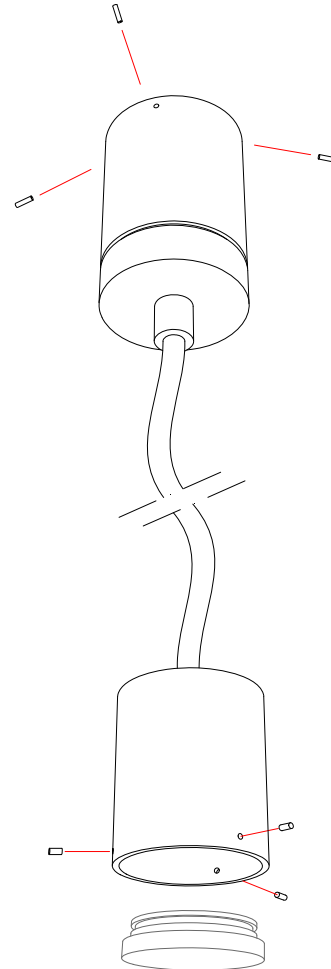
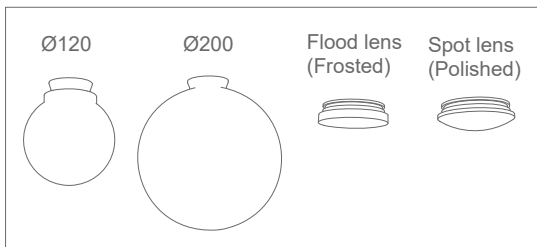

- ⚠ Repeat steps 2, 3 and 4 for 3 and 5 holes canopy.

 Ripetere l'operazione 2, 3 e 4 per il rosone da 3 e 5 fori.

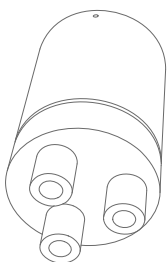

3 HOLES CANOPY

 ROSONE A 3 FORI

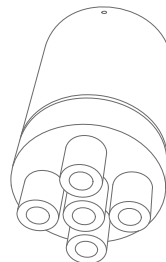

5 HOLES CANOPY

 ROSONE A 5 FORI